

PROJ. REFERENCE NO.	SHEET NO.
W-5805G	TMP - 12



USING FLAGGERS AND ROADWAY STANDARD
DRAWING 1101.02 SHEET 1 OF 19, CONSTRUCT
MONOLITHIC ISLAND.

USING ROADWAY STANDARD DRAWING
1101.02 SHEET 3 OF 19, CLOSE
THE LEFT LANE FOR SB US 1.

MATCHLINE -L- STA. 28+50.00
(SEE SHEET TMP 11)

REVISIONS

9/29/2025 R:\Projects\23-070.01 W-5805G\Traffic\TCP\Plan Sheets\Phase_2B\DDN Folder\W-5805G_Rdy_psh6 TCP IIB.dgn User:ksullivan

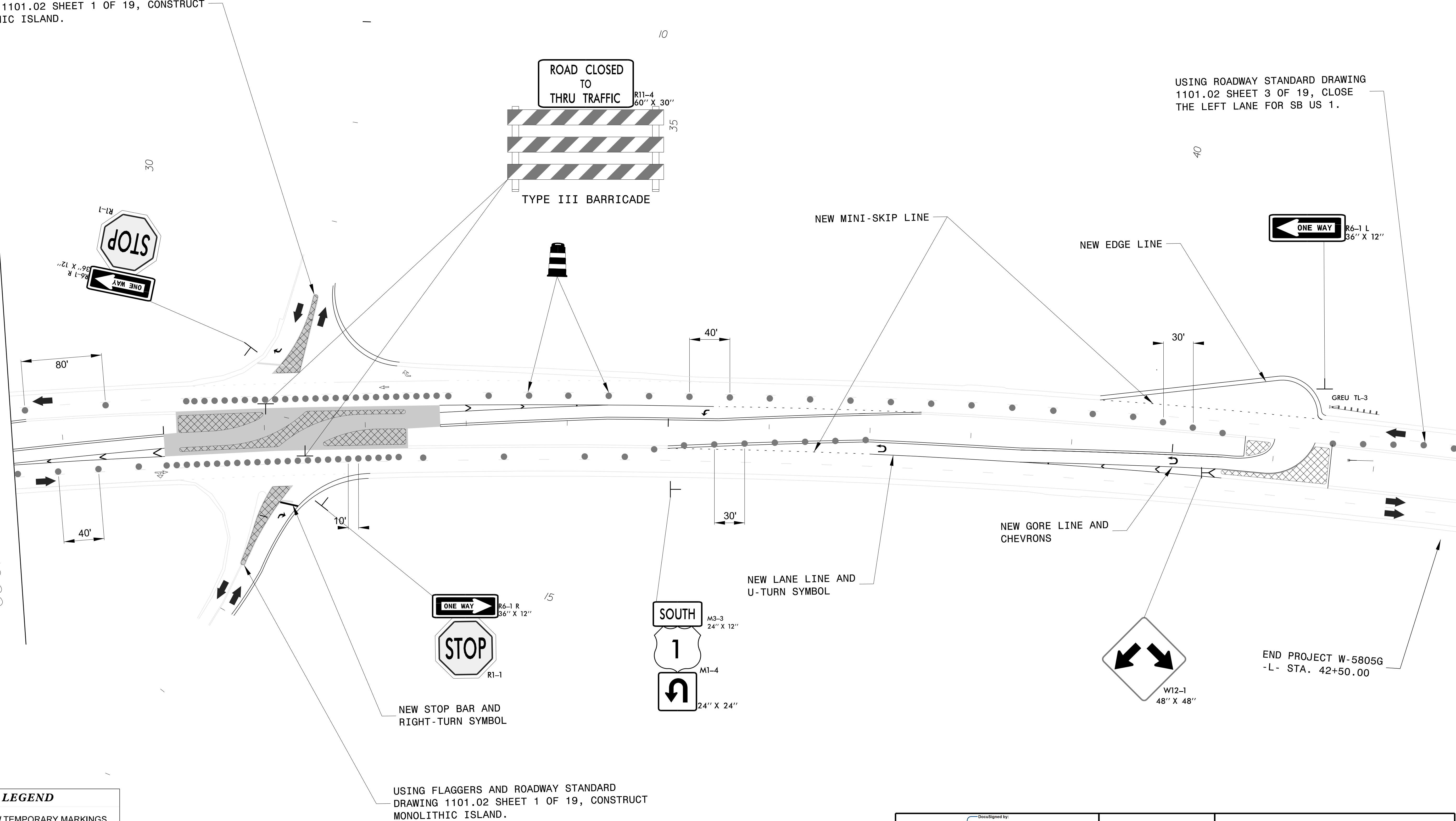

LEGEND

- NEW TEMPORARY MARKINGS
- EXISTING MARKINGS (GRAY)
- NEW CONSTRUCTION AREAS
- 5" MONOLITHIC ISLAND - (SURFACE MOUNTED)

NOTE: USE ROADWAY STANDARD DRAWING 1205.15 SHEET 1 OF 2
FOR PLACEMENT OF PAVEMENT MARKING.

NOTE: MAINTAIN DRIVEWAY ACCESS WHILE UNDER CONSTRUCTION.

NOTE: ALL LANE WIDTHS ARE 12' UNLESS OTHERWISE SHOWN.

USING FLAGGERS AND ROADWAY STANDARD
DRAWING 1101.02 SHEET 1 OF 19, CONSTRUCT
MONOLITHIC ISLAND.

ICE of
CAROLINAS, PLLC

ICE of Carolinas, PLLC
4505 Falls of Neuse Road, Suite 110
Raleigh, North Carolina 27609
Phone: 803-822-0333
License #: P-0999

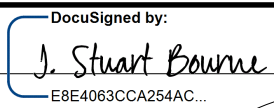
APPROVED: 
DATE: 9/29/2025

SEAL

**DOCUMENT NOT CONSIDERED FINAL
UNLESS ALL SIGNATURES COMPLETED**

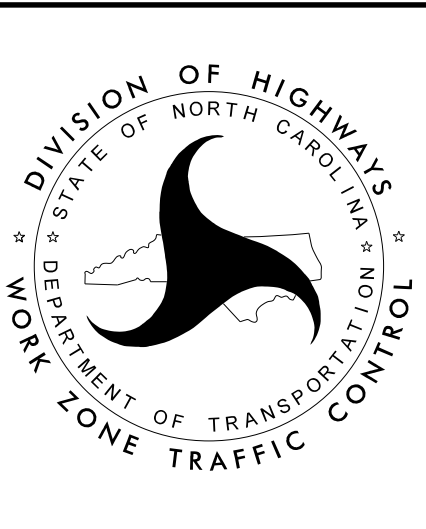

**TEMPORARY TRAFFIC
CONTROL
PHASE IIB DETAIL**